

Performance Ultra-stable
Advanced Functions
Convenient Operation

LZM-4T, 6T, 8T

Technical Parameters of LZM-4T, 6T, 8T Flow Meter

| Model | Measure Range | | Screw thread | Accuracy |
|--------|--|--|------------------------|----------|
| | ml/min (Liquid) | l/min (Gas) | | |
| LZM-4T | 6-60 8-80 40-400 | 0.1-1 0.2-2 0.25-2.5 1-10 1-12 | direct 6 | ±4% |
| LZM-6T | 6-60 10-70 GPH 16-160 80-400 100-500 100-600 200-800 100-1000 | 0.1-0.8 0.1-1.5 0.3-3 0.4-4 0.5-8 1-5 1-12 2-10 2-20 3-15 3-30 4-20 5-25 6-30 10-60 10-70 0.05-0.25 m³/h | M18 x 1.5 G1/4" BSP | |
| LZM-6 | 25-250 | 0.04-0.4 m³/h | tube | |
| LZM-8T | 2.5-25LPH 5-45LPH 6-60LPH | 0.16-1.6 m³/h 0.1-1 m³/h 0.2-2 m³/h | M18 x 1.5 G1/4" BSP | |

The outline size of LZM-4T, 6T, 8T Flow Meter

| Model | Size (mm) | | | | | |
|--------|-----------|----|----|----|---------|----|
| | A | B | C | D | E | F |
| LZM-4T | 94 | 27 | 21 | 14 | 14 | 70 |
| LZM-6T | 102 | 30 | 25 | 20 | M18x1.5 | 77 |
| LZM-6 | 120 | 29 | 29 | 28 | Φ9 | 90 |
| LZM-8T | 110 | 25 | 25 | 20 | M18x1.5 | 80 |

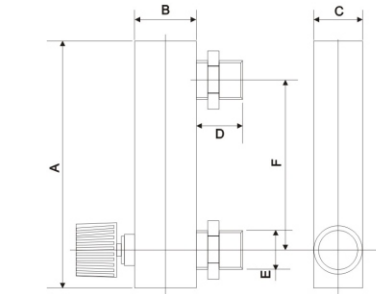

The material and code of the parts of LZM-4T, 6T, 8T Flow Meter

| With Valve | Valve | Fitting | Float | O-ring |
|------------|-------|------------------------|------------|-------------------|
| T- with | Brass | 1- ABS | ✓ SS | ✓1 Silicon rubber |
| O- No | ✓ SS | 2- PP | Acrylic | Fluorin rubber |
| | | 3- PVC | Agate ball | |
| | | 4- Brass | PTFE | |
| | | ✓ 5- Brass chromeplate | | 3- Butyl |
| | | 6- SS | | |



For Order: please specify the model, specification and code.
 Model Regulating Valve Measuring Range Material of the fitting Material of the O-ring
 LZM-

LZM-Z Series

Technical Parameters of LZM-Z series Flow Meter

| Model | Measure Range | | | Screw thread | Accuracy |
|----------|---------------|--|---|------------------|----------|
| | GPM (Liquid) | LPM (Liquid) | Nm³/h (Gas) | | |
| LZM-15ZA | | 15-150LPH | 0.1-1 0.3-3 0.4-4 | ZG1/2" 1/2" BSPT | ±4% |
| LZM-15Z | | 10-100LPH | | ZG1/2" 1/2" BSPT | |
| | | 16-160LPH | | | |
| | | 25-250LPH | 0.04-0.4 0.1-1 0.16-1.6 0.24-3 0.25-2.5 0.4-4 | | |
| | 0.03-0.35 | 0.1-1.4 | 0.6-6 0.8-8 | | |
| | 0.05-0.5 | 0.2-1.8 | 1-10 1.6-16 | | |
| | 0.1-1 | 0.5-4 | 1.8-18 2-20 | | |
| LZM-25Z | 0.15-1.5 | 0.6-6 | 2.4-24 2.5-25 | ZG1" 1" BSPT | |
| | 0.2-2 | 1-7 | 3-30 4-40 | | |
| | 0.3-3 | 1-11 | | | |
| | 0.5-5 | 2-18 | | | |
| | 1-10 | 5-35 | 2.5-25 | | |
| | 1-15 | 5-50 | 4-40 6-60 | | |
| | 2-14 | 10-50 | 10-100 20-100 | ZG1" 1" BSPT | |
| | 2-20 | 10-70 | 16-160 25-250 | | |
| | 5-35 | 10-130 | 30-300 35-350 | | |
| | 5-40 | 10-150 | | | |
| | 5-45 | 10-170 | | | |
| | | 0.3-2.1 m³/h 0.6-3 m³/h 0.6-4.2 m³/h | | | |

The outline size of LZM-Z series Flow Meter

| Model | Size (mm) | | | | | | | |
|----------|-----------|----|-----|----|----|-----|----|-----|
| | A | B | C | D | E | F | G | H |
| LZM-15ZA | 157 | 32 | 150 | 35 | 25 | 60 | 25 | 110 |
| LZM-15Z | 175 | 32 | 168 | 35 | 25 | 76 | 25 | 127 |
| LZM-25Z | 234 | 45 | 226 | 46 | 33 | 100 | 37 | 160 |

The material and code of the parts of LZM-Z series Flow Meter

| Fitting | Float | O-ring |
|---------------------|--------------|-------------------|
| ✓1 ABS | ✓1 SS | ✓1 Silicon rubber |
| 2 PP | 2 Acrylic | 2 Fluorin rubber |
| 3 PVC | 3 Agate ball | |
| 4 Brass | 4 PTFE | |
| 5 Brass chromeplate | | |
| 6 SS | | |

For Order: please specify the model, specification and code.
 Model Regulating Valve Measuring Range Material of the fitting Material of the O-ring
 LZM- Z

This series flowmeter has two models, it featured in beautiful look, with semicircle fittings and white colored tape, and there are two screws can easy installed on panel.

